



Features

PIM levels < -168 dBc
Excellent VSWR, 1.2:1 max.
Ideal for use in PIM laboratory testing.
Available in various connector options.

Overview

Impedance 50 Ohms
Frequency range DC-6 GHz

Configuration

Connector 1 7/16 DIN Male
Connector 1 specification IEC 169-4

Connector 2 mini DIN Male
Connector 2 specification IEC 169-4

Body style Straight
Adapter design Low PIM

Electrical Specifications @ +25°C		Unit
Frequency range	DC - 6	GHz
Maximum VSWR	1.20	:1
Passive Intermodulation (PIM)	< -168 @ +43 dBm per tone @ 1800 MHz	dBc
PIM Test Frequency	1800	MHz

Typical Performance @+25°C	DC-2 GHz	2-4 GHz	4-6 GHz
VSWR (S11 :1)	1.05	1.09	1.11

Mechanical Specifications	Connector 1	Connector 2
Inner conductor material/finish	Beryllium Copper/Silver	Beryllium Copper/Silver
Body material/finish	PIM rated Brass/Silver	PIM rated Brass/Silver
Wrench flat size	1.26 in.	.748 in.
Torque	18 - 22 ft. lbs.	8 - 12 in.. lbs.
Dielectric type	PTFE	PTFE
Mating cycles (typical) *	500 cycles	500 cycles
Weight	2.97, [84] oz. [gms]	
Length	1.67, [42.4] in. [mm]	
Width	1.26, [32] in. [mm]	

* Typical mating cycles is for VSWR performance only. PIM may degrade as matings increase.

Outline drawing

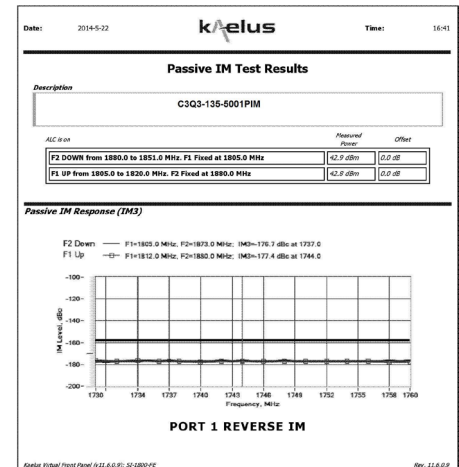
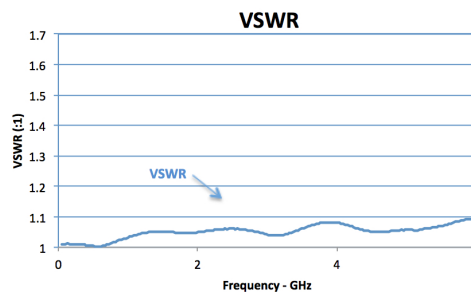
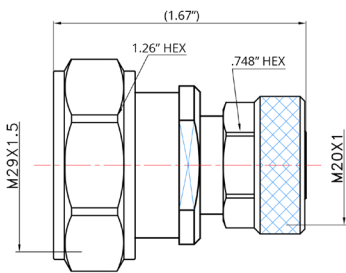

This C3Q3-135-5001PIM 50 ohm 7/16 DIN Male to mini-DIN Male Low PIM Adapter, is a between-series coaxial adapter product. This C3Q3-135-5001PIM 50 ohm 7/16 DIN Male to mini-DIN Male Low PIM Adapter, is precision engineered to strict industry specifications. This 50 ohm C3Q3-135-5001PIM 50 ohm 7/16 DIN Male to mini-DIN Male Low PIM Adapter, has broadband operation to 6.0 GHz. C3Q3-135-5001PIM 50 ohm 7/16 DIN Male to mini-DIN Male Adapter, has a straight body in a low PIM design. evissap offers its eP Low PIM adapters in a variety of connector interfaces and connector configurations. If you cannot find the exact eP Low PIM adapters you require, please submit a request along with your requirement information.

evissap reserves the right to change specifications, prices and any other information at any time without prior notice.

Document: C3Q3-135-5001PIM
Rev: --